

TAMTORQUE®

FIXING INSTRUCTIONS

IMPORTANT SAFETY INSTRUCTION

The Tamtorque safety buckle must always be used to prevent the end of the band being a safety hazard. If there is insufficient band protruding from the Tamtorque housing to enable the buckle to be fitted, the next larger size of Tamtorque clamp must be used. After final tightening, check

that the amount of band protruding from the buckle is not excessive and might still be a safety hazard. If necessary, unscrew the clamp sufficiently to free the buckle, reposition it in the 4th slot and re-tighten as illustrated in 4, 5 and 6 below.

When using power tools, the instructions supplied with the power tool must be followed and safety goggles worn.

TO COMPLETE AN ASSEMBLY

YOU SHOULD HAVE:-

2 off Tamtorque bands

1 off Tamtorque 50mm long special 1/4" hexagon power tool bit.

These bits can be used with a **ratchet spanner** with 1/4" socket drive bit or inserted directly into cordless drill/drivers.

Tightening of clamps is achieved using a cordless drill/driver and/or ratchet spanner.

NOTE:- BEFORE PROCEEDING WITH CORDLESS DRILL/DRIVER OPERATION ONLY PLEASE READ THE INSTRUCTIONS OVERLEAF.

GUK compatible bins include

- 1) Trimline 25 open top and hooded.
- 2) Trimline 35
- 3) Fido 25
- 4) Retriever 35

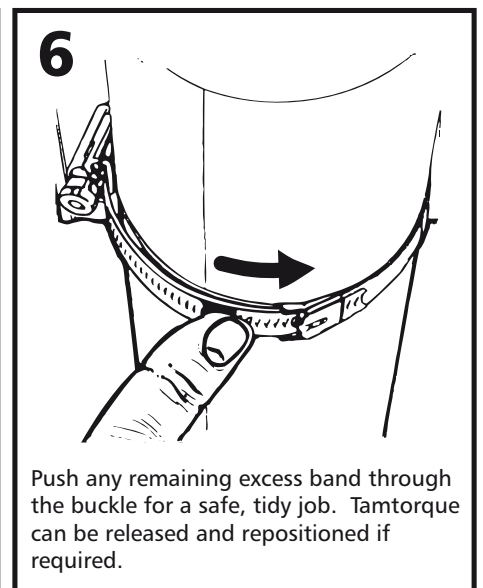
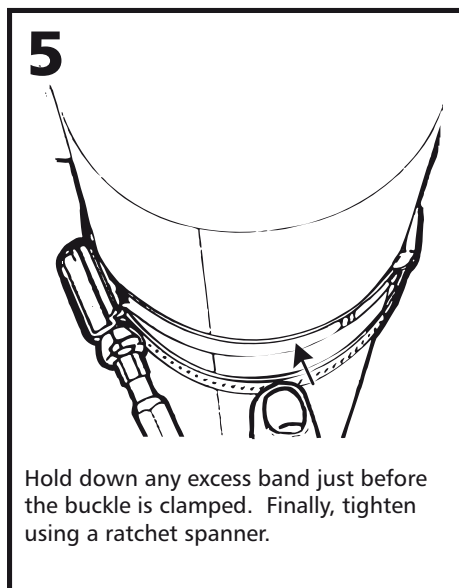
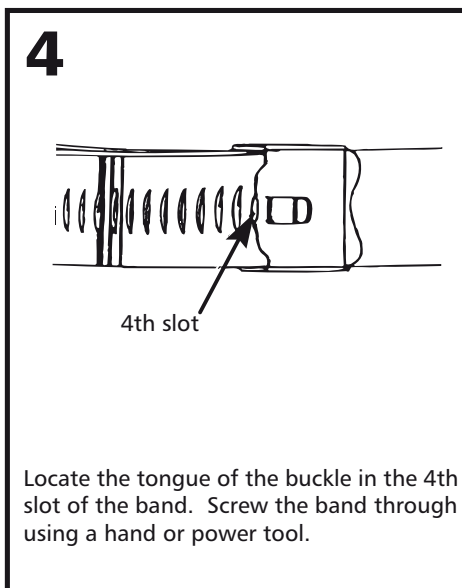
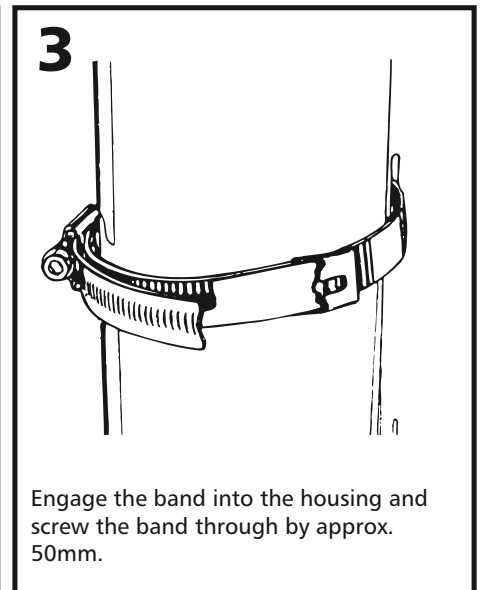
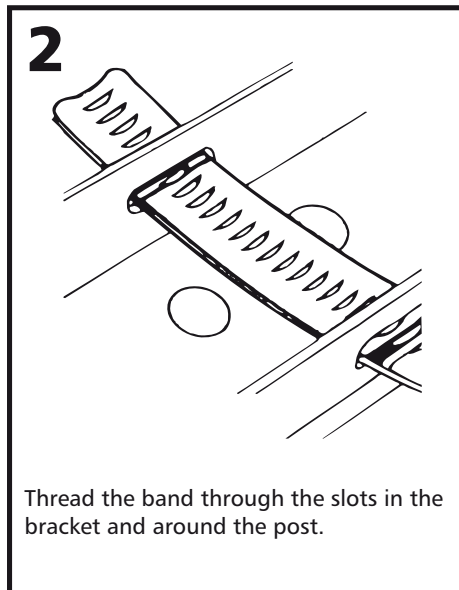
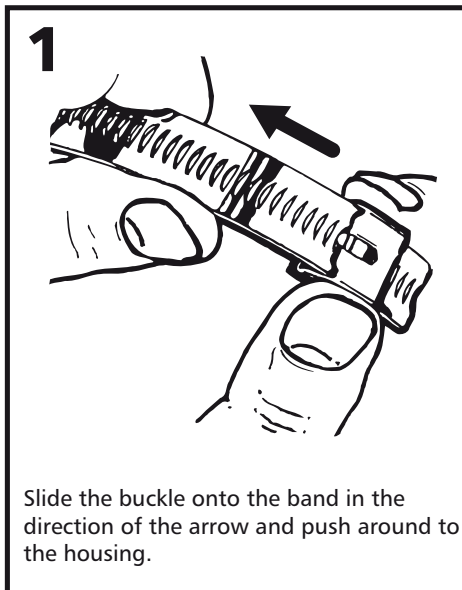

TIGHTENING TAMTORQUE CLAMP

Tamtorque clamps should always be tightened to between 10 and 15 Nm (90-130lb.in.). This torque can be achieved with a ratchet spanner.

THIS SHOULD ENSURE THAT:-

- a) the bin is securely clamped and highly resistant to being moved or rotated out of place.
- b) the tamper-resistant screw cannot be turned by pliers or by jamming a blade into the heptagon socket.

RECOMMENDED SECURING METHOD

A cordless power drill/driver is highly recommended to reduce the fixing time and the maximum clutch setting should be used (**but not the direct drive "drill" position**). On the maximum clutch setting, Tamtorque will be tightened to approximately 5 Nm, so final tightening should always be made using a **ratchet spanner**.

ALTERNATIVE CORDLESS DRILL/DRIVERS

Some cordless drill/drivers have a locked drive shaft when not being operated so that they may be used as a manual wrench. This method can be used for the final tightening of Tamtorque which will enable the whole operation to be performed quickly with just one tool. Contact your supplier for details of cordless drivers that have this function.

